

## Evopod Frame Assembly Instructions

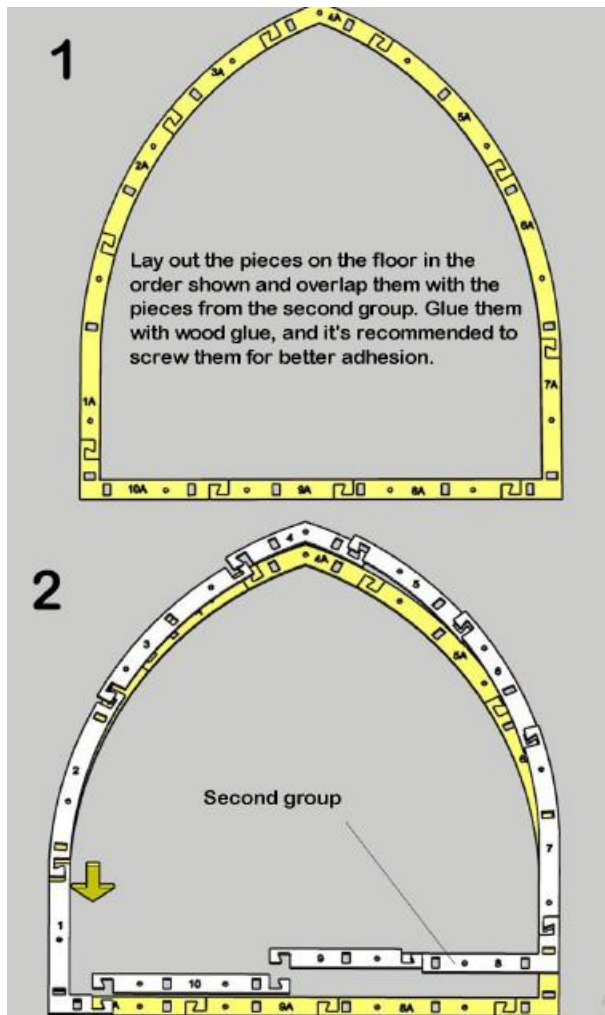

Each arch is made up of 20 parts from 1-10 and 1a-10a. It is important to have the diagram above in front of you when laying out the pieces on the ground. Some pieces are required to be flipped over if the number is backwards and identified by a “ ) ” next to the number. Currently the mirrored parts are 8), 2), 1), 4a), 7a), 1a), 8a). The reason for this is because we use what is called a nesting software to find the most efficient use of the plywood to avoid as much wastage as possible.

It is preferable to have a flat surface to lay out the arch pieces although we have done this on grass before. You can also lay 2 sheets of 4 x 8 plywood next to each other to help in assembly. The arch pieces will be the first to be assembled followed by the intermediate studs and the end studs and blocks.

**Tools and materials required.**

Titebond 3 PVA glue.

Drill with screw bit.

70 x 3" screws

60-70 x 1 ¼" screws per arch see chart below for number of arches based on length.

**Assembling Arches**

As mentioned having a flat surface approx. 8 x 8 such as a concrete slab or a deck will aid in the assembly of the arches.

First lay out the pieces numbered 1a-10a on the ground making sure to flip the mirrored numbers with the "J" around so that the number is facing down. The numbers will always be in a vertical position. It is usually easier to start at 1a and work around in a clockwise direction referencing the diagram provided. When all the pieces 1a-10a are laid out and joints fitted together. Lay out the pieces 1-10 loosely around the outside of the fitted 1a-10a pieces. This will allow you to easily place pieces and align while applying glue to the pieces 1a-10a. When laying pieces 1-10 on top of the pieces 1a-10a it is advisable to refer again to the diagram.

As you lay the 1-10 pieces on top of the 1a-10a pieces apply enough glue to adhere the top arch pieces one at a time to the bottom arch pieces and use the end block and end studs to align the stud holes together and the wiring holes while also aligning the outside edges of the arch. It is more important that the rectangular stud holes be aligned correctly since they require studs to fit in from either side. Apply the 1 ¼" screws in the middle of the joint flanges and also provide at least one screw in the mid section of each arch pieces. Additional screws can be applied as necessary. Once screws have been applied to the top surface flip the arch over and apply the 1 ¼" screws to the other side of the arch in the same way as previously done.

Repeat for all arches.

**Assembling intermediate studs and wedges.**

Once the arches have been assembled the next step is to connect the intermediate studs into the arch frame from either side and use the wedges ( making sure the 90 degree angle of the wedge is against the arch face ) see diagram below.

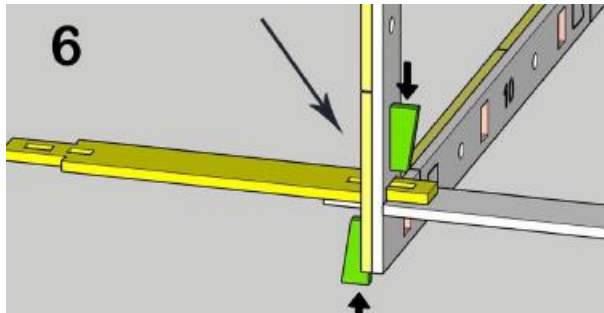

It is recommended to install bottom intermediate studs which will allow the arch to stand vertically while the other intermediate studs and wedges are applied to the curved sections of the arch. We also recommend dry installing the wedges at first until all the intermediate studs are in place and then apply glue to the wedges. Glue is normally applied to the middle section of the wedges which is the normal contact point for the wedges in the joint.

It is usually helpful to raise bottom edge of arch up in order to place the bottom wedges in from below.

Make sure that the intermediate studs on the curved sides of the arch alternate between upper and lower intermediate studs and that the base intermediate studs alternate left and right.

### **Assembling end studs blocks and end arches.**

Before attaching the end studs to the end arches make sure the end space block is glued and screwed to the short end of the end stud as shown below.

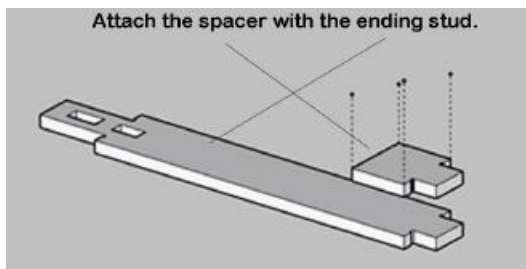

Once the blocks have been attached to the end studs they can now be inserted into the end arch rectangular holes (apply glue to the part of the end stud and block that goes into the arch holes) and then secure with two 3" screws either side of the hole as shown below. It is best to install all end studs into the end arch holes before installing 3" screws.

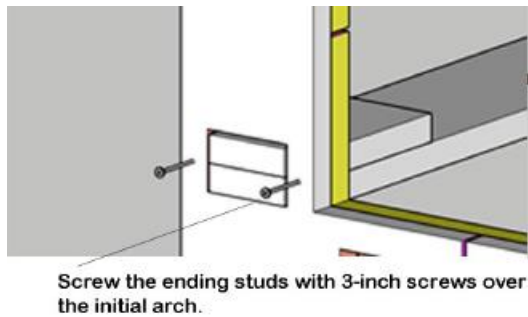

## **Kit Contents**

In your Evopod Gothic frame kit you will receive:

32 end studs: these studs connect from an inner arch to an outer arch. I.e the outer arch is the last arch at either end of the EvoPod frame.

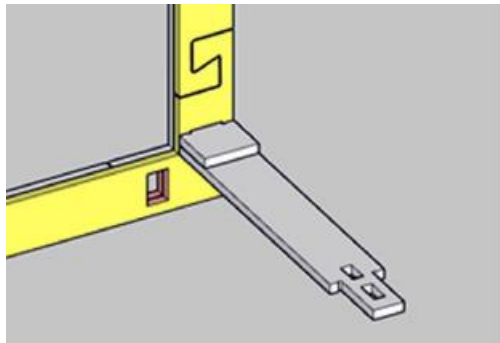

32 End stud spacer blocks: The end spacer blocks are attached to the short end of the end studs using screws or nails at the four corners shown.

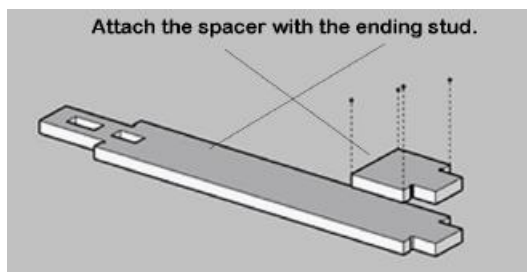

Intermediate studs: The number of intermediate studs will vary depending on the length of the EvoPod Frame kit purchased. Please see chart below for number based on length.

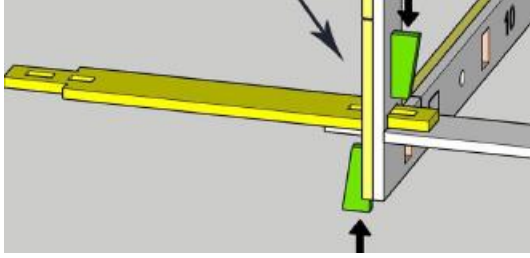

Wedges: The number of will vary depending on the length of the EvoPod Frame kit purchased. Please see chart below for number based on length.

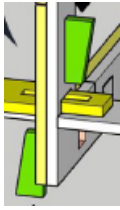

Arch pieces: The number of arches will vary depending on the length of the EvoPod Frame kit purchased. Please see chart below for number based on length.

Size ( L x W)	# Arches (20 pieces per arch)	# Int. Studs	#Wedges	#End Studs	#End Blocks
20' x 8'	11	128	288	32	32
18' x 8'	10	112	256	32	32
16' x 8'	9	96	224	32	32
14' x 8'	8	80	192	32	32
12' x 8'	7	64	160	32	32
10' x 8'	6	48	128	32	32
8' x 8'	5	32	96	32	32
6' x 8'	4	16	64	32	32